

Soils Map

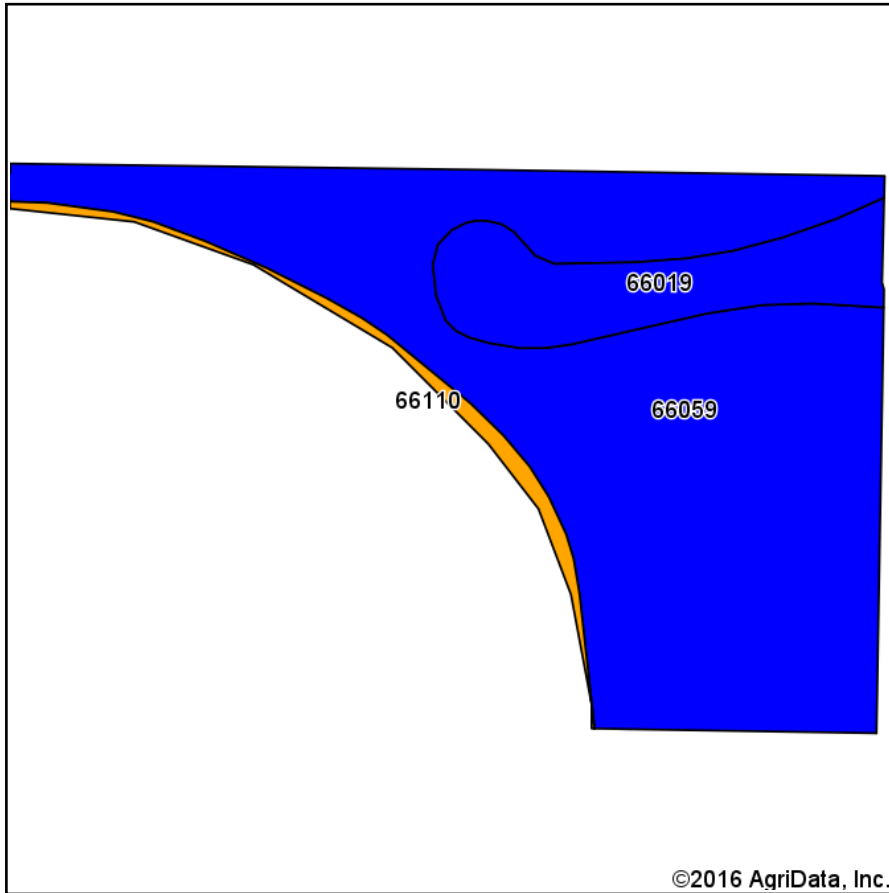

Soils data provided by USDA and NRCS.

©2016 AgriData, Inc.

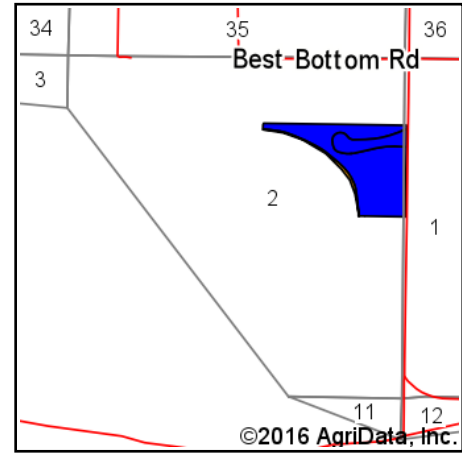

State: **Missouri**
 County: **Montgomery**
 Location: **1-45N-6W**
 Township: **Loutre**
 Acres: **38.7**
 Date: **10/18/2016**



Area Symbol: MO139, Soil Area Version: 13

Code	Soil Description	Acres	Percent of field	Non-Irr Class Legend	Non-Irr Class *c	Common bermudagrass	Orchardgrass red clover	Tall fescue	Warm season grasses
66059	Peers silty clay loam, 0 to 2 percent slopes, occasionally flooded	32.01	82.7%		IIw	8	9	8	10
66019	Lowmo silt loam, 0 to 2 percent slopes, occasionally flooded	5.48	14.2%		IIw	8	7	7	9
66110	SansDessein silty clay, 0 to 2 percent slopes, occasionally flooded	1.21	3.1%		IIIw	8	7	8	9
Weighted Average						8	8.7	7.9	9.8

Area Symbol: MO139, Soil Area Version: 13

*c: Using Capabilities Class Dominant Condition Aggregation Method

Soils data provided by USDA and NRCS.